

460 NORTH HARMONY DRIVE

2015

Investigation of illegal sewer connections revealed three (3) illegal connections. All downspouts have been corrected and are in compliance at this time.

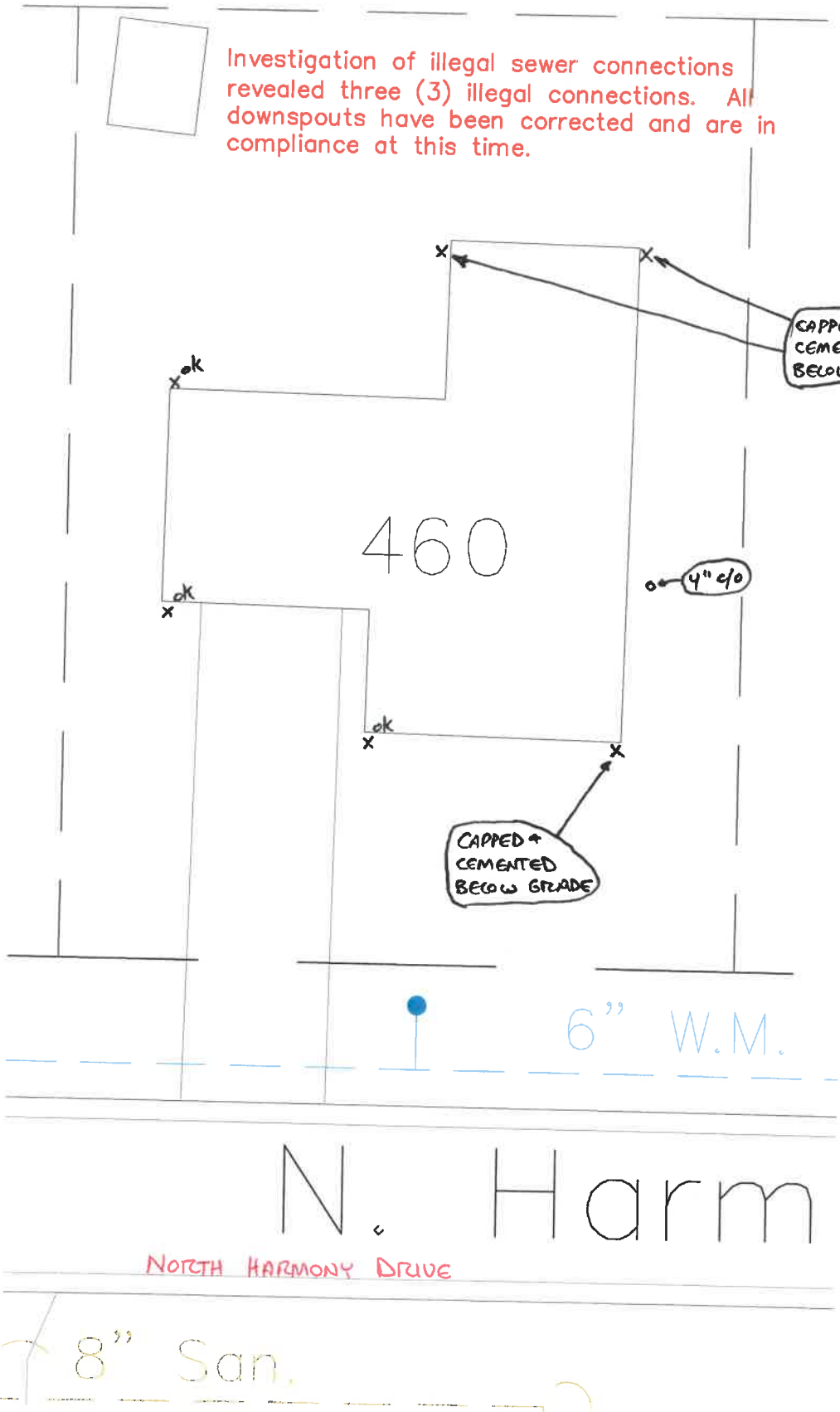

CAPPED + CEMENTED BELOW GRADE

CAPPED + CEMENTED BELOW GRADE

4" c/o

6" W.M.

N. Harm

NORTH HARMONY DRIVE

8" San.

SCANNED